

2024

NEWEA ANNUAL CONFERENCE & EXHIBIT

NEWEA 2024 Annual Conference & Exhibit *One Water: All for One and One for Water*

January 21–24, 2024
Boston Marriott Copley Place
Boston, Massachusetts



January 21–24, 2024

Boston Marriott Copley Place Hotel
Boston, Massachusetts

New England Water Environment Association
10 Tower Office Park, Suite 601
Woburn, MA 01801-2155
(T) 781-939-0908 (F) 781-939-0907
www.newea.org | mail@newea.org



Dear Water Quality Professional,

The New England Water Environment Association (NEWEA) invites you to join us in Boston, MA during January 21–24th for the 2024 NEWEA Annual Conference & Exhibit. This **prestigious water quality conference** brings together water quality professionals to exchange ideas, learn, and debut cutting-edge technology and innovative products.

This event will attract more than 2,200 attendees, providing your company the best opportunity to **attract new prospects, introduce new products and give product demonstrations to buyers** in the water industry. The conference features 30+ technical sessions and one centrally-located Exhibit Area on two interconnected floors with over 200 booths.

To provide the best experience for all exhibitors and attendees, machinery or any part of an exhibitor’s display should not extend outside the boundary of your contracted exhibit space. Display materials should be arranged in such a manner so as not to obstruct sight lines of neighboring exhibitors and across the hall. These guidelines must be followed at all times.

Book Early to Save Money and Secure Your Exhibit Space!

Be among those who take advantage of this opportunity and book your booth space by November 14th to receive the discounted booth fee. Booths may be selected through the interactive on-line exhibit registration system.

Don’t miss your opportunity to join us! If you need more information, please contact Paul Russell, Exhibits Chair, prussell@r-r-inc.com or contact Janice Moran, NEWEA at 781-939-0908 or jmoran@newea.org.

We look forward to seeing you in Boston!

Paul Russell, Exhibits Committee Chair

AS AN EXHIBITOR, YOU GET FREE PROMOTION IN NEWEA’S PUBLICATIONS!

- On-site Official Conference Program
- NEWEA Mobile App
- Online Exhibitor Directory
- NEWEA Journal Spring Issue
- Conference Announcements

In order to have your company listing appear in the publications, space reservation must be received by the preregistration deadline and space fees must be current.

CONNECT WITH NEWEA ON SOCIAL MEDIA



Gain Additional Exposure

Get additional valuable exposure and increase awareness for your company by becoming a conference sponsor; participating in the exhibitor directory (printed and online); or by placing ads in the NEWEA Journal.

About NEWEA

Established in 1929, the New England Water Environment Association is a dynamic organization of over 2,100 water quality professionals who are dedicated to the preservation of water quality and water resources throughout New England



EXHIBIT AT NEWEA'S PRESTIGIOUS WATER QUALITY SHOW

BOOTH EQUIPMENT AND SERVICE INFORMATION

The Exhibit Area will be centrally located on the 3rd and 4th floors interconnected by an internal stairwell at the Boston Marriott Copley Place Hotel. Exhibits will be open Monday through Wednesday.

Each booth space rented will include the following:

- One 10'W x 8'D exhibit booth space, ceiling is 8' high (exhibit area is carpeted)
- 8' high back drape and 3' high side rails
- One 2' x 6' draped and skirted table
- 7" x 44" exhibitor identification sign
- Two folding chairs and wastebasket
- Four exhibit personnel admittance badges
- Additional Free Exhibit Hall Passes
 - Good for Wednesday, January 24, 2024
- Online access to proceedings

Additional exhibit hall passes and event tickets may be purchased separately online or on-site.

Electricity and other utility connections are not provided with the space but can be ordered through Encore (the Marriott Hotel's Audio Visual company). The order form is posted in the [Exhibitor Service Center](https://annualconference.newea.org/exhibitor-service-center/)- <https://annualconference.newea.org/exhibitor-service-center/>. NEWEA assumes no responsibility or liability for any of the foregoing services performed and materials delivered.

RESERVE ONLINE: <https://shows.map-dynamics.com/newea2024/?register>

EXHIBIT BOOTH RATES

| | "Discount" Registration* | Standard Registration* |
|----------------------------|--------------------------|------------------------|
| Exhibit Booth (10'W x 8"D) | \$1425.00 | \$1650.00 |

*Exhibit space must be secured on-line on or before Tuesday, November 14, 2023 to qualify for the discounted registration rate.

RESERVE YOUR BOOTH SPACE

The on-line exhibit registration will open Monday, September 18, 2023. Booths may be selected through the on-line interactive floor plan. Exhibit spaces are immediately assigned and confirmations emailed upon receipt of successful application!

DATES TO REMEMBER

| | |
|--------------------|---|
| September 18, 2023 | General Booth Sales open |
| November 14, 2023 | Preregistration rate end |
| January 5, 2024 | Final booth payment due |
| January 9, 2024 | Exhibitor Directory and name badges due |

EXHIBIT HALL SCHEDULE

| Sunday, January 21, 2024 | |
|-----------------------------|-------------------------------|
| 12:00 Noon - 6:00 PM | Exhibitor Set-up (3rd floor) |
| 2:00 PM - 6:00 PM | Exhibitor Set-up (4th floor) |
| Monday, January 22, 2024 | |
| 8:00 AM - 10:00 AM | Exhibitor Set-up |
| 10:30 AM - 6:30 PM | Exhibit Area Open |
| 4:30 PM - 6:30 PM | Exhibit Reception (3rd floor) |
| Tuesday, January 23, 2024 | |
| 8:00 AM - 6:30 PM | Exhibit Area Open |
| 4:30 PM - 6:30 PM | Exhibit Reception (4th floor) |
| Wednesday, January 24, 2024 | |
| 8:30 AM - 1:00 PM | Exhibit Area Open (public) |
| 11:00 AM - 1:00 PM | Exhibit Brunch (3rd & 4th) |
| 1:00 PM - 3:00 PM | Exhibitor Breakdown |

The exact times for exhibitor set-up will be finalized in the confirmation email from NEWEA sent prior to the event.



EXHIBITOR BENEFITS

The New England Water Environment Association’s 2024 Annual Conference and Exhibit in Boston, MA will be a gathering of water quality professionals who are committed to preserving, protecting and managing the water environment. The Exhibit Area will showcase products, services and educational opportunities for water quality professionals.

Exhibit space entitles you to many benefits and services:

- Exhibitors may list their company under a category to allow attendees to quickly locate your company.
- Dedicated exhibit time, including receptions, coffee breaks and brunch (Wed.) held in the Exhibit Area.
- Recognition as an exhibitor in the official conference program.
- Complimentary listing in the online exhibitor directory.
- One centrally-located Exhibit Area on two floors.
- Sponsorship opportunities to promote your company.
- Complimentary final registration list from previous Annual Conference.
- Four complimentary badges to attend the conference.
- Entertainment stations located around the Exhibit Area.
- Free Exhibit Hall Passes - Good for Wednesday, January 24, 2024



TECHNICAL PROGRAM — HEAR THE LATEST TOPICS AND TRENDS IN THE INDUSTRY

Take advantage of 30+ technical sessions and keep your employees abreast of new trends in the industry! Sessions include: Asset Management, Collection Systems, Contaminants of Emerging Concern, CSO/Wet Weather Issues, Diversity, Equity & Inclusion, Energy, Government Affairs, Industrial Wastewater, Laboratory Practices, PFAS, Plant Operations, Public Awareness, Research, Residuals Management, Safety, Small Community Outreach, Stormwater, Sustainability, Utility Management, Water Reuse, Watershed Management, Young Professionals and Youth Education.

NETWORK WITH OTHER WATER QUALITY PROFESSIONALS

The Annual Conference and Exhibit is a prestigious water quality conference in New England. Its ongoing success can be attributed to its attendees and exhibitors. The conference continues to draw all types of water professionals in the industry. Whether you want to network with an educator, plant operator, engineer, or scientist, we’ve got you covered.

Annual Conference* Registrants’ Primary Job Functions

| | |
|-----|--|
| 151 | Educators and Students |
| 425 | Engineering and Design Staff |
| 664 | Engineering, Laboratory, Operations Management |
| 378 | Purchasing/Marketing/Sales |
| 397 | Operations |
| 97 | Other (Regulators, Public Officials, etc.) |
| 84 | Scientific and Research Staff |

*Data from 2023 in-person conference

Annual Conference Attendance Figures

| | 2020 | 2021* | 2022 | 2023 |
|------------------|-------|-------|-------|-------|
| Attendees | 1,706 | 805 | 838 | 1,399 |
| Exhibitors | 828 | 52 | 752 | 797 |
| Total Attendance | 2,535 | 857 | 1,590 | 2,196 |

*2021 virtual conference

EXHIBIT TERMS — OFFICIAL RULES AND REGULATIONS

1. LOCATION OF EXHIBITS

The exposition will be held at the Marriott Copley Place Hotel, Boston, Massachusetts. All measurements and booth layouts shown on the floor plan are as accurate as possible, but **the New England Water Environment Association (NEWEA) reserves the right to make such modifications and changes in booth assignments as may be necessary to adjust the floor plan at any time to meet the needs of NEWEA, its Attendees and Exhibitors.**

2. DISPLAY SPACE

All display areas will be marked off by the official service contractor. Standard booth size is 10'W x 8'D with a maximum ceiling height of 8' high unless otherwise noted on the floorplan.

Under no circumstances may machinery or any part of an exhibitor's display extend outside the boundary of your contracted exhibit space. To maintain fairness to all exhibitors, display materials should be arranged in such a manner so as not to obstruct sight lines of neighboring exhibitors. Clear lines of sight to neighboring booths and the entire hall must be maintained at all times.

Each booth will include one 6' draped table, two chairs, wastebasket, side-rails and drape backdrop for each booth in addition to one company identification sign.

3. EXHIBITOR EQUIPMENT

Exhibitors shall notify the NEWEA office with any specific requests pertaining to oversized equipment or other items. NEWEA holds the right to deny exhibitors permission to show specific pieces of equipment, displays, etc., based on dimensions and/or weight.

4. APPLICATIONS

Applicants must secure an exhibit booth through the on-line exhibit registration. Final payments must be received by Friday, January 5, 2024 to secure exhibit booths. Credit cards are accepted. Make checks payable to NEWEA, 10 Tower Office Park, Suite 601, Woburn, MA 01801

5. ASSIGNMENT OF SPACE

Priority of space assignments will be based upon availability on a first-come, first-served basis with preference given based on past participation. General registration will be available September 18, 2023. Exhibitors who desire assignment next to each other should purchase booths together on-line. **A discount will be offered for registrations received prior to Tuesday, November 14, 2023.**

6. INSTALLATION HOURS

Sun., Jan. 21, 12-6:00 PM (3rd floor)
Sun., Jan. 21, 2:00-6:00 PM (4th floor)
Mon., Jan. 22, 8:00-10:00 AM

All exhibits must be set up by 10:00 AM on Monday, January 22, 2024.

Only exhibitors with badges will be permitted to enter the exhibit area during hours of installation and dismantling.

7. DISMANTLING OF EXHIBITS

No packing or dismantling of exhibits will be allowed until the official closing of the exhibit area at 1:00 PM on Wednesday, January 24th.

Failure to abide by this policy will result in loss in booth selection preference priority for the 2025 Annual Conference.

All exhibits must be removed from the exhibit area by 4:00 PM on Wednesday, January 24th. Materials not removed by this time will be put in storage at the Exhibitor's expense.

There is no space available for storage of empty cartons, crates, etc. Arrangements may be made with the exhibit service contractor for storage.

8. UNLOADING/LOADING OF MATERIALS FOR INSTALLATION/DISMANTLING

The unloading and loading of materials and equipment is governed by Boston Union Guidelines.

Hand Carry - Exhibitors may hand carry one item, one time, in or out of the facility without having to access the loading dock.

Hand-carried is defined as one item that can be easily carried by an individual, without the need for dollies or other mechanized equipment weighing less than 30 lbs. Unions claim jurisdiction under all other circumstances. **Privately Owned Vehicles - Exhibitors may load and unload: Automobiles, Station Wagons, Mini Vans, SUVs, Pick-Up Trucks and Vans. Exhibitors may use their own equipment limited to carts, dollies, and hand trucks.** Exhibitors can not use motorized or hydraulic devices. Any vehicle requiring dock use is under Union jurisdiction.



9. EXHIBIT HOURS

Morning and afternoon breaks along with two evening receptions will be served in the exhibit hall. Please refer to the final program for times.

Mon., January 22, 10:30 AM-6:30 PM
Tues., January 23, 8:00 AM-6:30 PM
Wed., January 24, 8:30 AM-1:00 PM

10. EXHIBITOR SERVICE MANUAL

The manual will be posted on-line and will contain order forms and shipping instructions from the official service contractor for your booth space. The service contractor will notify exhibitors electronically prior to the Exposition. **Note: electricity is ordered directly through the hotel with PSAV.**

11. EXHIBITOR REPRESENTATIVES

Exhibits must be staffed at all times during the exhibit hours. Each exhibiting company will receive a specific number of complimentary badges. Additional and replacement badges are available for purchase.

EXHIBIT TERMS — OFFICIAL RULES AND REGULATIONS

12. FAILURE TO OCCUPY SPACE

Any space not occupied by 10:00 AM, Monday, **January 22, 2024** will be forfeited by the exhibitor. This space may be reassigned or used by NEWEA without refund, unless arrangements for delayed occupancy have received prior approval from NEWEA.

13. EXHIBIT FACILITY

The Exhibitor assumes responsibility and liability for losses, damages and claims arising out of injury or damage to the Exhibitors' displays, equipment and other property brought upon the premises of the Boston Marriott Copley Place Hotel and shall indemnify and hold harmless the Hotel and NEWEA and their agents, servants and employees from any and all such losses, damages and claims. There is no other agreement or warranty between the Exhibitor and NEWEA except as set forth in this document. The rights of NEWEA under this contract shall not be deemed waived except as specifically stated in writing and signed by an authorized officer of NEWEA.

14. SECURITY AND INSURANCE

NEWEA will provide security service from 12:00 Noon, January 21, 2024 through 1:00 PM January 24, 2024 during the hours when the exhibit area is not open to the public. However, the Exhibitor is solely and fully responsible for his/her own exhibit material and should insure his/her exhibit against loss or damage from any causes whatsoever. Security for booths outside of the Exhibit Hall will be limited as booths outside of Exhibit Hall are accessible during periods when the exhibits are not

open. All property of the Exhibitor is understood to remain in its care, custody, and control in transit to or from or within the confines of the Boston Marriott Copley Place Hotel.

15. CARE OF BUILDING AND EQUIPMENT

Exhibitors, or Agents, must not injure or deface the walls or floors of the building, the booths, or the equipment of the booths. When such damage appears, the Exhibitor is liable to the owner of the property so damaged. All materials used in decorations must be flameproof. Electric wiring must conform to Electric Code Safety Rules, and all applicable fire laws, electrical codes and other laws, which affect the installation, conduct and disassembly of the exhibit. Combustible material or explosives are not permitted in the exhibit hall. The Exhibitor shall also comply with all reasonable requests of officials of the Boston Marriott Copley Place Hotel with respect to installation, conduct and disassembly of its exhibit.

16. COVID-19

Exhibitors are responsible for keeping their space sanitized. NEWEA in conjunction with the Boston Marriott Copley Place Hotel will be responsible for sanitizing the general areas of the exhibit hall and meeting space.

NEWEA expects that in-person attendance may be lower than previous years. It is impossible to guarantee the number of attendees that will attend in person, and therefore exhibitors agree to accept the number of attendees without grievance.

Regulations set forth by NEWEA, the state of Massachusetts, city of Boston and the Boston Marriott Copley Place Hotel will be followed, including but not limited to: social distancing, the wearing of masks, and other such rules, etc. These guidelines are subject to change.

17. CANCELLATION OF EVENT

In the event that it is necessary to cancel a portion of or all of the NEWEA 2024 Annual Conference and/or the exhibits, due to any cause beyond the direct control of NEWEA including, but not limited to damage to or destruction of the convention and exhibit building, labor strikes, adverse weather conditions, the Exhibitor shall be reimbursed only for actual direct costs not incurred by NEWEA.

"Out of the Member Association shows that I attend, this one is by far the best...hands down!"

-Annual Conference Exhibitor

18. CANCELLATION OF EXHIBIT REGISTRATION

In the event that an Exhibitor desires to cancel a reservation, NEWEA must receive a request for cancellation in writing and a refund will only be granted if NEWEA is able to fill the reserved booth with a replacement Exhibitor.

19. CONTACT: EXHIBIT

NEWEA Office, 10 Tower Office Park, Suite 601, Woburn, MA 01801
Phone: 781-939-0908
Email: mail@newea.org

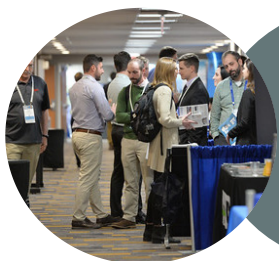
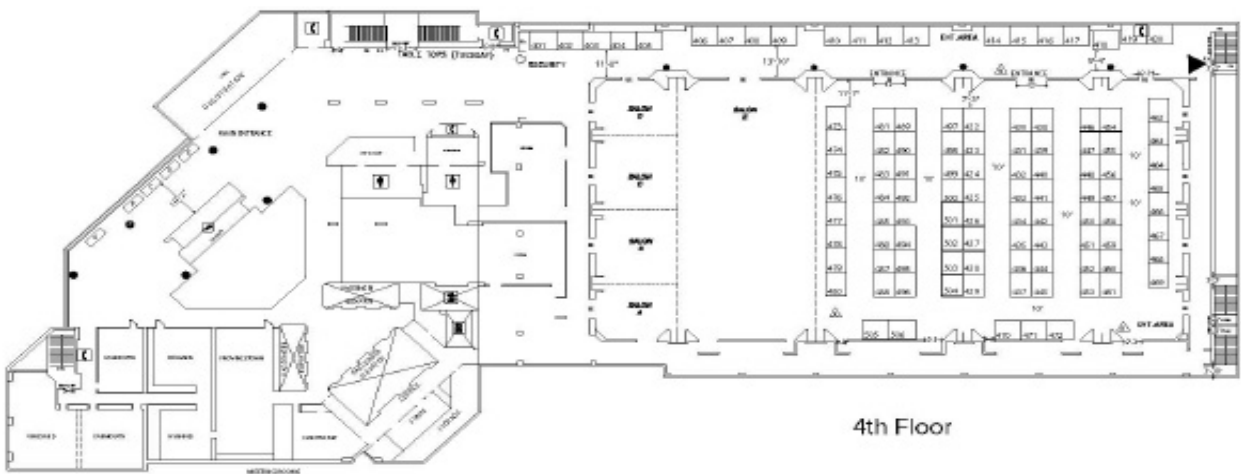
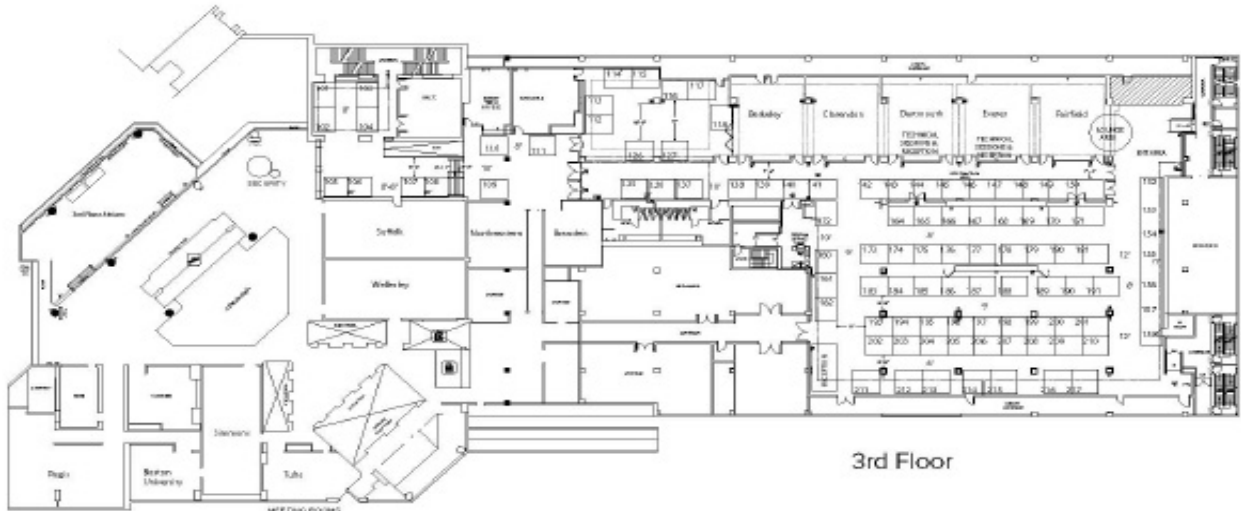

EXHIBIT FLOORPLAN

EXHIBIT BOOTHS ARE AVAILABLE ON THE 3RD AND 4TH FLOORS OF THE BOSTON MARRIOTT COPLEY PLACE HOTEL IN BOSTON, MA. ONLINE EXHIBIT REGISTRATION WILL OPEN ON SEPTEMBER 18, 2023. AVAILABILITY SUBJECT TO CHANGE.

Marriott Copley Place Hotel—NEWEA Conference Floor Plans



LIST OF PAST EXHIBITORS*

| | | | |
|---------------------------------|----------------------------------|----------------------------------|---------------------------------|
| ABBA Pump Parts and Service | EOSi | McIntosh Controls | Sodimate |
| ADS LLC | EST Associates | McMillen Jacobs Associates | SONETICS Corp. |
| AECOM | EV Systems New England | Mechanical Solutions, Inc. | Sprayroq |
| Aeromod | Evoqua Water Technologies | Meridian Associates, Inc. | SPX Flow, Inc. |
| Aerzen | F.R. Mahony & Associates | Methuen Construction | Stacey DePasquale Engineering |
| Air Clean USA - WESCOR | Fab-Tech | MIH Trident | STATIFLO CORPORATION |
| Alfa Laval | Ferguson Waterworks | Mission Communications | StormTank |
| AMP Electrical | Five Star Filtration - WESCOR | MixTec | StormTrap |
| Amwell, Inc. | Flottweg USA | MPE | Sullivan Associates/Ritec |
| Andritz Separation | Flow Assessment Services | National Water Main Cleaning Co. | Environmental |
| Anua International | Flow Tech, Inc. | NECI | Summit Builders, LLC |
| APTIM | Flowserve | New England CHP TAP | Synagro Northeast, LLC |
| Aqua Solution, Inc. | Fluid Conservation Systems | New England Combined Heat and | Tank Connection |
| Aqua-Aerobics | Fournier | Power Technical Assistance | Technology Sales NE |
| Aqualitec | Frazenburg Centrifuges | Partnership | Teledyne Isco |
| Aquametrix by Water Analytics | GA Fleet | New England Environmental | The MAHER Corporation |
| AquaPoint | GEA | Equipment | Thermal Process Systems |
| Aquarius Technologies | GeoTree Solutions | Nexom | Ti-SALES |
| AquaTurbo Systems - WESCOR | Glasco UV - WESCOR | Next Rung Technology | Tigg |
| Aries Industries | GNA LTD | Next Turbo Technologies | Tomorrow Water |
| Asahi/America, Inc. | Gorman Rupp Pumps | NORESCO | Toshiba |
| Atlantic Fluid Technology Inc. | GP JAGER INC. / Aqua Aerobic | NOV | Trillium Flow - WESCO |
| Atlas Copco - Siewert Equipment | GP JAGER INC. / Vaughan | Nuvonic | Triplepoint Environmental |
| Barton & Loguidice, DPC | GP JAGER INC. / JWCE | Oakson | Troy Valve, Inc. |
| BAU/Hopkins | Grande, Inc. | Oldcastle Infrastructure | Truax Corporation |
| BCR, Inc. | Green Mountain Pipeline Services | Omya, Inc. | UET Mixers - WESCOR |
| BDP Industries | Griffco Valve | Onsite Engineering, Inc. | UGSI |
| BioChem Technology, Inc. | Grundfos | Orege North America | United Concrete Products |
| Biorem | Hach Company | Orenco Water | United Industrial Products |
| BioSafe Systems, LLC | Hach Flow Group | Ovivo/Varec Biogas | USABUEBOOK |
| Blue-White | Harmon & Co., Inc. | Parkson - WESCOR | UV Pure Technologies, Inc. |
| BMC Corp. | Hayes Group | POND Technical | VACCON |
| Boyson & Associates, Inc. | Hayward Gordon | Posm software | Vapex |
| Brentwood Industries | Hazen and Sawyer | Precision Group | Vaughn Chopper Pumps |
| Brown and Caldwell | Hidrostal LLC | Precision Industrial | VEGA Americas |
| Burt Process | High Tide | Precision Systems | Velodyne |
| C.N. Wood Co., Inc. | Hobas Pipe USA, Inc. | PRIMEX Controls | Veolia Water Technologies |
| Cambridge | Holland Company | Prominent - WESCOR | Verder |
| Carl Lueders & Company | Homa Pump | Protectolite | Vermeer All Roads |
| Carlsen Systems, LLC | Howden | Pump Systems Incorporated | Viking Chain |
| Carter Pump | Huber Technology | PureAir Filtration | VIR Proteus |
| Casella | Hydro-Action | PVP | Vogelsang USA - WESCOR |
| Centrisys | IDI | PW Tech | Vortex Companies |
| Chadwick-BaRoss, Inc. | Industrial Flow Solutions | Quantum Biopower | VTScada |
| Champlin Associates, Inc. | Infiltrator Water Technologies | Raco | Waco Products |
| Chart, Inc. | INFOSENSE, Inc. | Rain for Rent | Walker Wellington |
| Charter Machine | Inland Waters | Rausch USA | Wastecorp Pumps - WESCOR |
| Chemscan - WESCOR | InnovaTreat - WESCOR | RCAP Solutions | Wastewater Works, Inc. |
| Claro | Inovair | RCM Pump Systems | WATERLINE |
| Continental Blower | INVENT | REA Resource Recovery Systems | Watson Marlow |
| Continental Carbon | Ipex Vortex Flow | Red Valve | WeCelebrate |
| Cornell Pump | Ishigaki USA - WESCOR | RedZone Robotics | Wescor Associates, Inc. |
| Corrosion Products & Equipment | Ixom Watercare | Resource Management, Inc. | WesTech |
| Coyne Chemical Environmental | J&R Sales and Service, Inc. | Rexa | Westlake Pipe & Fittings |
| Services | JDV Equipment - WESCOR | Righter Group / Tnemecc | Whipps, Inc. |
| Crane Pumps & Systems | John Cockerill Environment | Rodney Hunt - WESCOR | Williamson Electrical Co., Inc. |
| CUES, Inc. | JWB Company | Russell Resources | Wilo |
| Danfoss LLC | JWC Environmental | Saf-T-Flo | WSG & Solutions |
| Denali Water Solutions | Kaeser | Sanitaire/Xylem | Xylem Dewatering |
| DeNora | Kemira | Sanitary Equipment Co., Inc. | Xylem Inc. - Flygt Pumps |
| DN Tanks | Kiewit | Saveco - WESCOR | Xylem Water Solutions |
| Duke's Root Control | Kleinfelder | Savy & Sons | YSI |
| Duperon Corporation | Koester Associates / Kubota | Scavin Equipment Company LLC | Zoeller |
| Dutchland, Inc. | Koester Associates / Rexa | Schneider Electric / FOXBORO | |
| Eastech | Koester Associates / Roto Pumps | Schwing | |
| ECS | KSB, Inc. | Sealing Systems, Inc. | |
| EJ | Kusters Water | Seepex | |
| Electro Scan | Lakeside Equipment | Sentrol, Inc. | |
| Elite Water Solutions - WESCOR | LandTech Consultants, Inc. | Shelter Works | |
| Emerson | Loprest | Siewert Equipment | |
| Enereau Systems Group, Inc. | Lutz Jesco Corp/ | Smart Cover Systems | |
| Environment One Corporation- A | M.A Selmon Company | Smith and Loveless | |
| PCC Company | Maltz Sales Company | SNF Polydyne | |
| ENZ | Mass Tank Inspection & Services | | |

*2023 exhibitor list